



233-400 Fliptop Manual - Roof system for lengths up to 6m

Fliptop Manual is our manual system, which opens from one side and uncovers it for loading. Fliptop Manual Maneuvers with a lever in the front or back depending on demand and space.

Ends and the longitudinal tube are made of galvanized steel. All moveable tubes and linkage in the ends are manufactured in aluminum to save weight and make the roof easier to open. The opening lever has a position lock when opened and closed. A draw wire is connected to the lock that automatically opens when the wire is charged. All the fulcrums is stored with bearing bushes.

System:

233-400 Fliptop Manual

This includes: Gable without lever, Gable with lever, Central tube, Side tube, Screw kit, Tie down rings and Draw wire.

Tarpaulin:

233-000-1 Fliptop Manual tarpaulin single layer	L=4-5m
233-000-11 Fliptop Manual tarpaulin single layer	L=5-6m
233-000-2 Fliptop Manual tarpaulin double layer	L=4-5m
233-000-22 Fliptop Manual tarpaulin double layer	L=5-6m
233-000-3 Fliptop Manual tarpaulin isolated layer	L=4-5m
233-000-33 Fliptop Manual tarpaulin isolated layer	L=5-6m

This includes: tarpaulin and mounting details.

Accessories:

188-569-2 Straight bracket for side tube.

188-570-2 Angle bracket for side tube

233-112 QuickLock

233-580 Stop sleeve, QuickLock

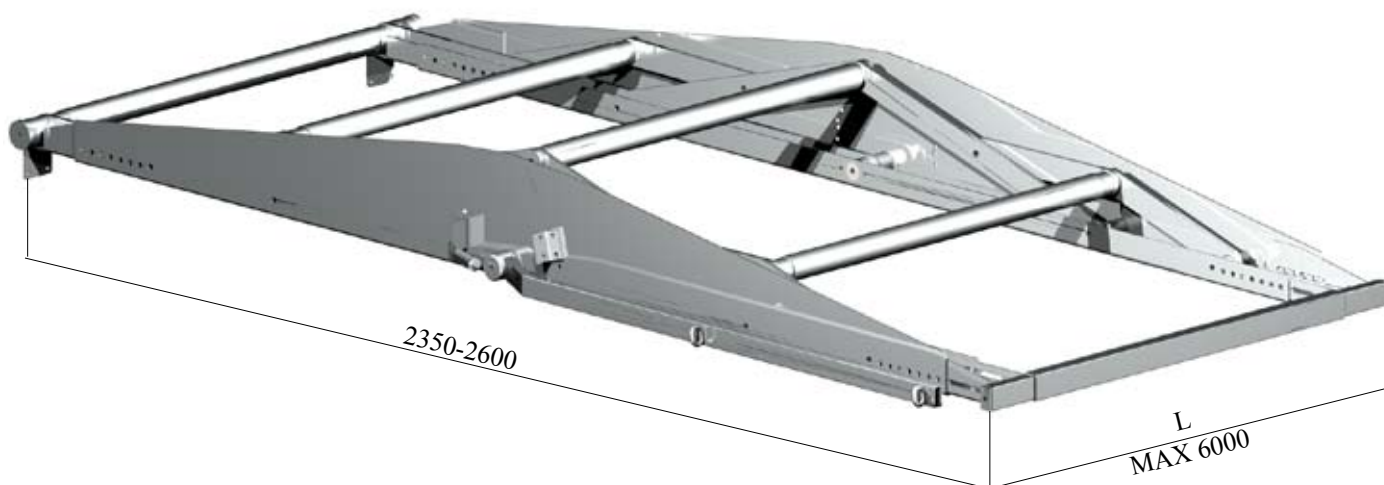

Article list - art.nr. 233-400

- 1 st **233-401** Gable with handle
Aluminum and galvanized
34 kg



- 1 st **233-402** Gable
Aluminum and galvanized
29 kg



- 1 st **12329 FZB** Steel tube 50x30x2
Galvanized L=6000
2,4 kg/m

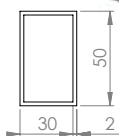

- 4 st **72861** Aluminum tube 50x2
L=6000
0,9 kg/m

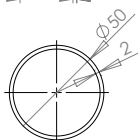

- | | |
|-------------------------------|---------------------|
| 1 st 233-150 Screw kit | 1 kg |
| 4 st M8x20 | 20 st washer 9x28x2 |
| 2 st M8x45 | 2 st Tie down rings |
| 8 st M8x65 | 4 st Rope Clamps |
| 10 st M8 Locknut | |

- 1 st **233-154** Draw wire

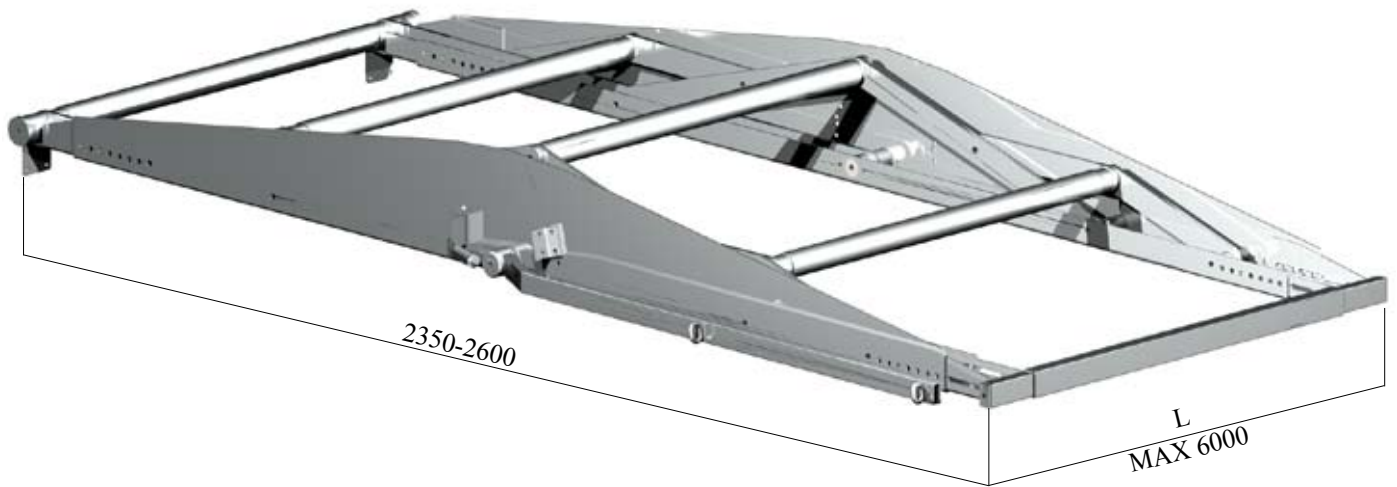

Article list - art.nr. 233-400 Accessories

188-569-2 Bracket
Galvanized
0,4 kg



188-570-2 Bracket
Galvanized
0,1 kg



233-112 QuickLock
Stainless steel
1 kg



233-580 Stopp
Stainless steel
0,1 kg

