



800-(005/006) Fliptop Multi Pneumatic - Roof systems for lengths up to 9m

Fliptop Multi Pneumatic is our system that opens from the middle to the sides, the opening is done by a pneumatic cylinder, mounted in the front or back. Long systems have cylinder in both ends. Cylinders and flow control valves are included in the system, but the control valves are excluded. Valves for control are ordered separately, we have a number of different alternatives, and most common is 5/3 manual with closed center. We also provide complete maneuver systems with remote control and receiver. The system is galvanized and all the fulcrums are stored with bearing bushes.

System:**800-005-6 Fliptop Multi Pneumatic 2200-2400 6M****800-006-6 Fliptop Multi Pneumatic 2400-2600 6M**

This includes: Gable without cylinder, Gable with cylinder, Central tube, Side tube, Screw kit and Flow control valves in the cylinder.

800-005-7 Fliptop Multi Pneumatic 2200-2400 7M**800-006-7 Fliptop Multi Pneumatic 2400-2600 7M**

This includes: Gable without cylinder, Gable with cylinder, Central tube, Side tube, Screw kit, Middle support arc and Flow control valves in the cylinder.

800-005-9 Fliptop Multi Pneumatic 2200-2400 7-9M**800-006-9 Fliptop Multi Pneumatic 2400-2600 7-9M**

This includes: 2 st Gables with cylinder, Central tube, Side tube, Screw kit, Middle support with middle tubes connected and Flow control valves in the cylinders.

Tarpaulin:**188-000-2 Fliptop Multi Pneumatic Tarpaulin Single layer L=4-5M****188-000-22 addition Multi Pneumatic for lengths over 5M****188-000-7 Fliptop Multi Pneumatic Tarpaulin Double layer L=4-5M****188-000-77 addition Multi Pneumatic for lengths over 5M****188-000-8 Fliptop Multi Pneumatic Tarpaulin Isolated layer L=4-5M****188-000-88 addition Multi Pneumatic for lengths over 5M**

This includes: Cover and mounting details.

Accessories:**188-569-2** Straight bracket for side tube.**188-570-2** Angle bracket for side tube.



Article list - art.nr. 800-(005/006)-6

1 st **800-109 (2200-2400)**
800-111 (2400-2600)
Gable with cylinder
Galvanized
46 kg



1 st **800-102 (2200-2400)**
800-104 (2400-2600)
Gable
Galvanized
29 kg

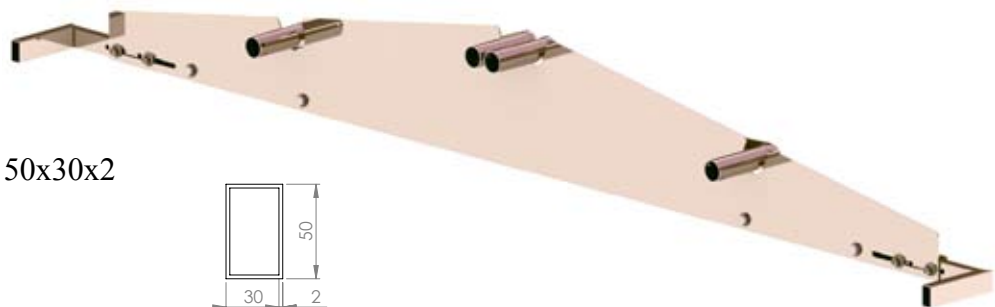

1 st **12329 FZB Steel tube 50x30x2**
Galvanized L=6000
2,4 kg/m

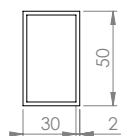

4 st **18622 FZB Steel tube 50x1,5**
Galvanized L=6000
1,8 kg/m

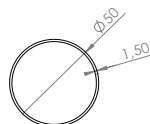

1 st **800-119 Screw kit**
4 st M8x45
8 st M8x65
12 st M8 Locknut

24 st washer 9x28x2

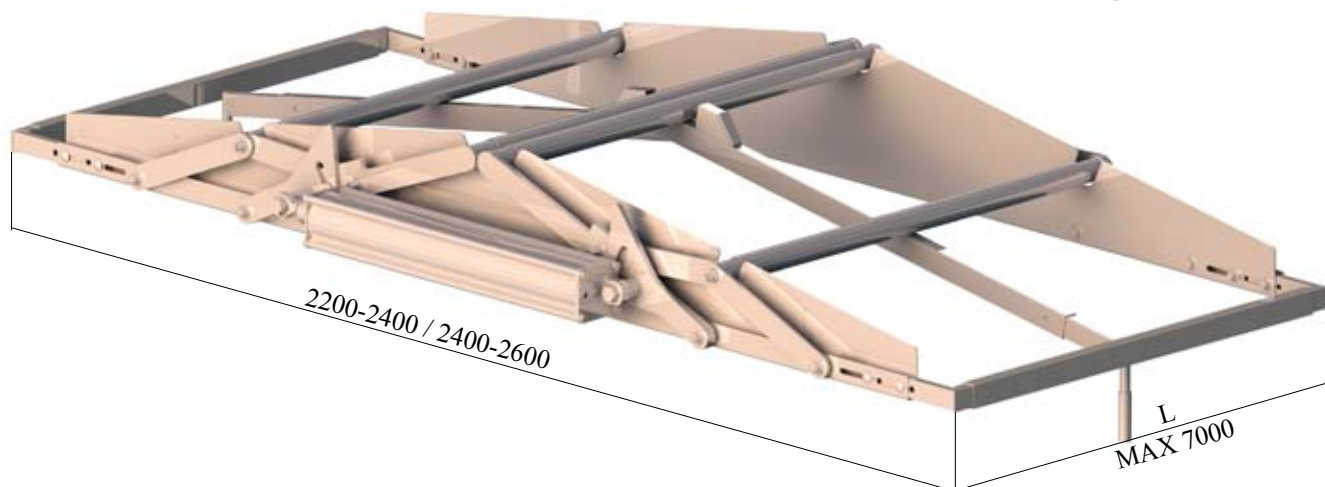

Article list - art.nr. 800-(005/006)-7

1 st **800-109 (2200-2400)**
800-111 (2400-2600)
 Gable with cylinder
 Galvanized
 46 kg



1 st **800-102 (2200-2400)**
800-104 (2400-2600)
 Gable
 Galvanized
 29 kg

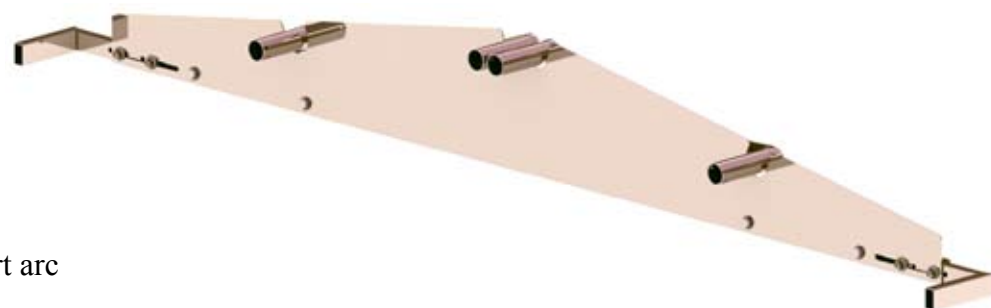

1 st **800-117** Middle support arc
 Galvanized
 8 kg



1 st **12329 FZB** Steel tube 50x30x2
 Galvanized L=6000
 2,4 kg/m

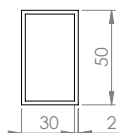

4 st **18622 FZB** Steel tube 50x1,5
 L=7000
 1,8 kg/m

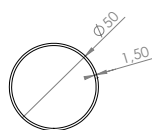

1 st **800-119** Screw kit
 4 st M8x45
 8 st M8x65
 12 st M8 Locknut

24 st Washer 9x28x2



Article list - art.nr. 800-(005/006)-9

- 2 st **800-109 (2200-2400)**
800-111 (2400-2600)
 Gable with cylinder
 Galvanized
 46 kg



- 1 st **800-120 (2200-2400)**
800-118 (2400-2600)
 Middle support with middle tubes connected
 Galvanized
 27 kg



- 1 st **12329 FZB Steel tube 50x30x2**
 Galvanized L=6000
 2,4 kg/m

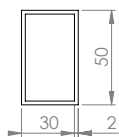

- 4 st **18622 FZB Steel tube 50x1,5**
 Galvanized L=9000
 1,8 kg/m

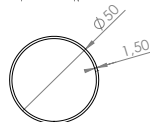

- 1 st **800-119 Screw Kit**
 4 st M8x45
 8 st M8x65
 12 st M8 Locknut

- 24 st Washer 9x28x2



Article list - art.nr. Multi Pneumatic Accessories

188-569-2 Bracket
Galvanized
0,4 kg



188-570-2 Bracket
Galvanized
0,1 kg

